



# LANDSCAPE STRUCTURE PLAN - KEY PROJECTS AND IMPLEMENTATION PLAN

# LANDSCAPE STRUCTURE PLAN - KEY PROJECTS

Below are a list of key projects of the Landscape Structure Plan. The following key projects will be progressed alongside several supporting strategies and sub-plans for the site, including a companion animals management plan, among other plans (refer to page 68 for a full list of these plans).

The focal areas for the projects below include the waterfront and the central parkland spaces, linking the waterfront to Balmain Road.

1. Prioritise the waterfront - create new waterfront open green space by removing intrusive buildings on the waterfront, extending pedestrian access via a pathway from Wharf Road to the waterfront, and providing new park facilities including new accessible amenities
2. Provide new carpark at Wharf Road with safe and accessible pedestrian access to the waterfront and sporting grounds, provide disabled parking and a 'kiss and ride' drop off area at Waterfront sports ground
3. Close Waterfront Drive to vehicular traffic and upgrade the Bay Run, providing separate pedestrian and cycling paths
4. Improve protection for the Aboriginal cultural heritage and bushland at Callan Point
5. Commence the restoration of Building 497 for community and sports use
6. Restore heritage buildings for community reuse including Gary Owen Summerhouse and Bonnyview (the Chaplain's cottage) in a way that is complementary to the park setting
7. Repair the seawall, and provide estuarine habitat opportunities
8. Remove intrusive buildings 499 and 511 at Waterfront Green and Waterfront Sports
9. Adaptive reuse of the Cane Room B512 for a community use complementary to the park setting
10. Remove intrusive buildings on Callan Point and design with native species. Restore rocky shore edge as a natural landscape.
11. Restore and reinstate the original heritage and wrought iron sandstone gates at the main entry to Callan Park
12. Provide a playground at Waterfront Sports Ground and explore feasibility of adaptive reuse of B496 as part of the playground
13. New open green space in Central Green and an accessible path network, remove buildings 201, 207, 209, 210 and service roads. Explore the feasibility of adaptive reuse of 208.
14. Connect the Central Green to Balmain Road by a visually non-intrusive low impact pathway that is respectful of heritage and topography
15. Reuse the pool as a water harvesting or water treatment reservoir and amphitheatre
16. Amphitheatre and shelter around the bowling green
17. Remove intrusive buildings around Balmain Road sporting ground, upgrade oval and provide a sports pavilion
18. Expansion of community/ cultural facilities complementary to Writing NSW
19. Restore the Convalescent cottages with select views to Iron Cove, and remove building 488
20. Potential harbour swim site to be located in consultation with Council.
21. Existing dog off leash areas to be retained and new off leash opportunities to be explored during consultation in early 2021 on a Companion Animals Management Plan.



# LANDSCAPE STRUCTURE PLAN - IMPLEMENTATION PLAN

The stages below outline the proposed implementation plan for the first stages of work at Callan Park. The priority would be on improving and opening up the waterfront for parkland use.

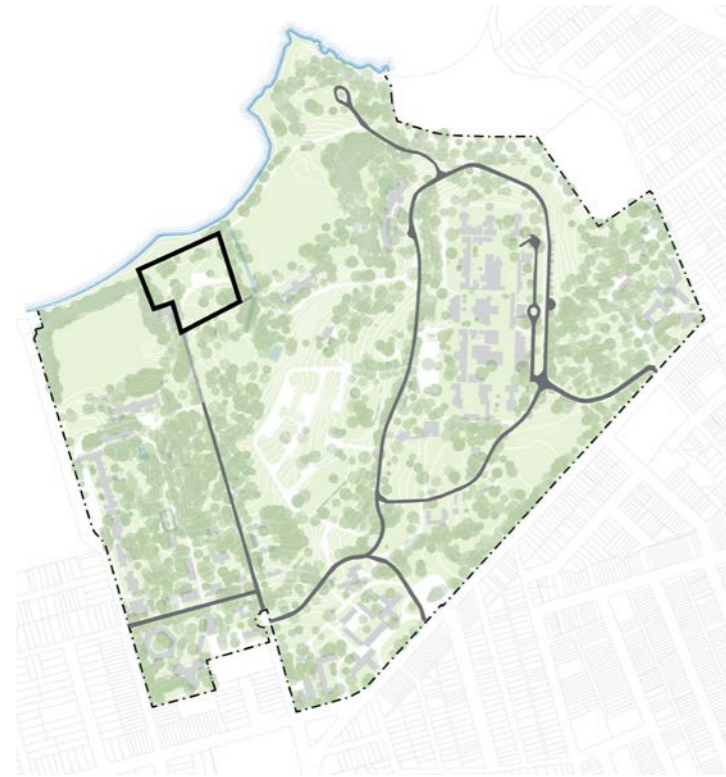

## STAGE 1 WATERFRONT GREEN

1. Remove buildings 505,514
2. Remediate demolition areas and re-turf
3. Treat any contamination
4. New accessible amenities block
5. New turf, paths and picnic facilities
6. New tree planting



## STAGE 2 BAY RUN UPGRADE & WHARF ROAD CARPARK

1. Build Wharf Road carpark and shoulder parking, and remove parking from Waterfront Drive
2. Build new accessible path extension from Wharf Road to Waterfront Drive with lighting
3. Build kiss and ride drop off, accessible parking bay and emergency access to Waterfront Sporting Ground
4. Remove Waterfront Drive vehicle access
5. Build new Bay Run, including separate pedestrian and cyclist paths lighting to P2 standards. Allow emergency and service access to Callan Point
6. Fix sea wall along Waterfront Drive and Callan Point where necessary
7. New turf and planting along waterfront edge
8. Improved bridge crossing and Bay Run alignment at waterfront canal

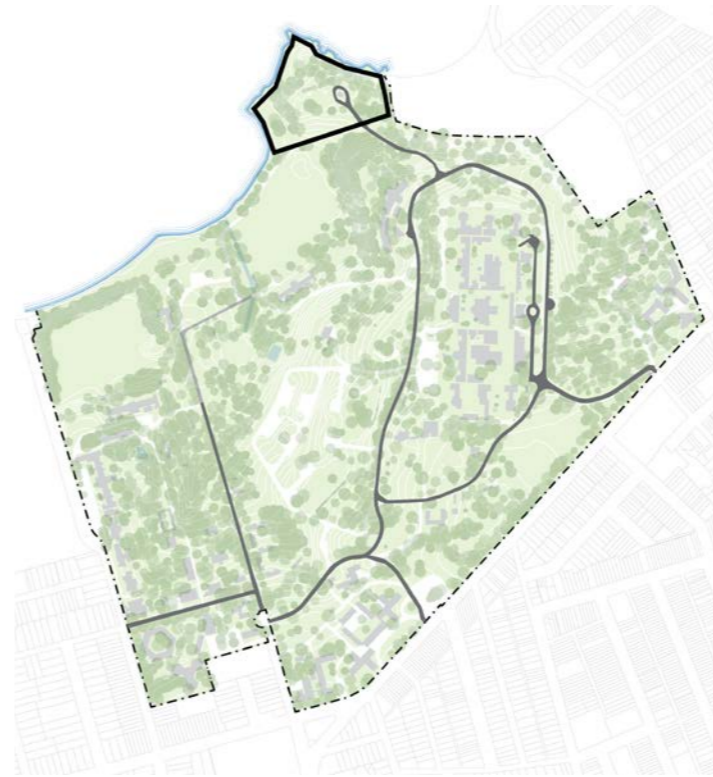

## STAGE 3 CALLAN POINT

1. Protect rock engravings and indigenous plantings
2. Headland park works including new trees, planting and paths
3. New picnic facilities and paths along waterfront
4. Repair and activate Garry Owen Summer House



## STAGE 4 WATERFRONT SPORTS

1. Upgrade B497 allowing for a sporting and community facility
2. New concrete terraces with turf sitting areas facing sporting fields
3. New paths, tree planting, seating and picnic facilities

## SUPPORTING STRATEGIES AND SUB-PLANS

In order to support the implementation of the Landscape Structure Plan, a number of supporting strategies and subplans are to be developed. These include:

- Companion Animals Management Plan
- Callan Point Heritage and Ecological Management Plan
- Tree Management Plan and Urban Forest Framework
- Comprehensive building condition audit, maintenance plans and structural assessment of buildings
- Pedestrian Entry and Wayfinding Strategy
- Safety, Access and Inclusion Plan
- Heritage Conservation Management Plan Review
- Holistic Traffic Management Plan

These plans will be developed in collaboration with stakeholders, government agencies and the community.

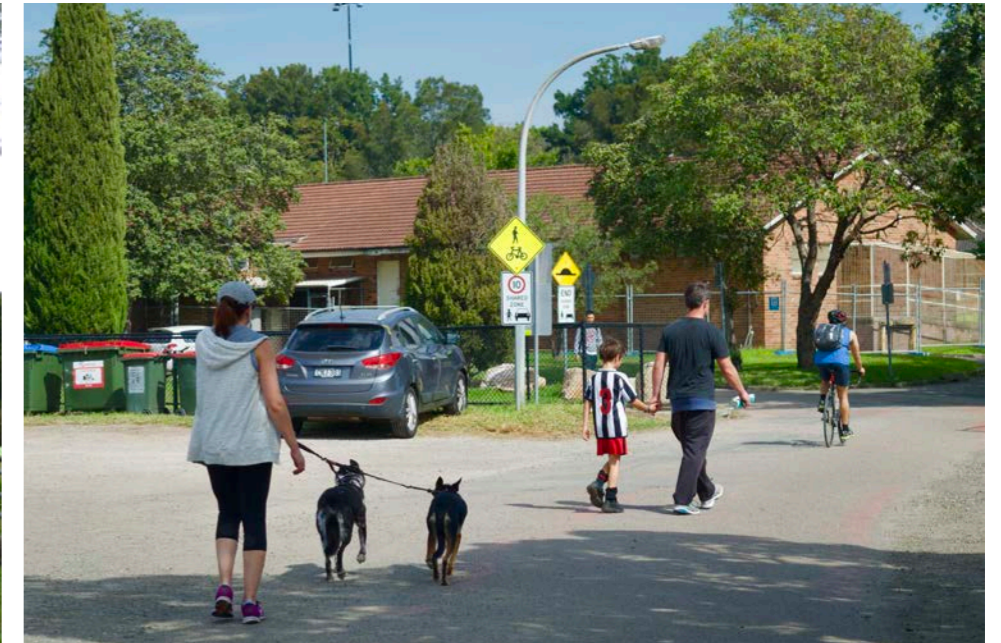

## CALLAN POINT

This artist's impression shows how Callan Point could retain its rock outcrops and indigenous vegetation while improving access to the waterfront with more green space.



# THE WATERFRONT GREEN

This artist's impression shows how the Bay Run could be completed by removing vehicle access and providing more green space on the waterfront.



## THE CENTRAL GREEN

This artist's impression shows how the heart of Callan Park could feature more open green space and accessible pathways.



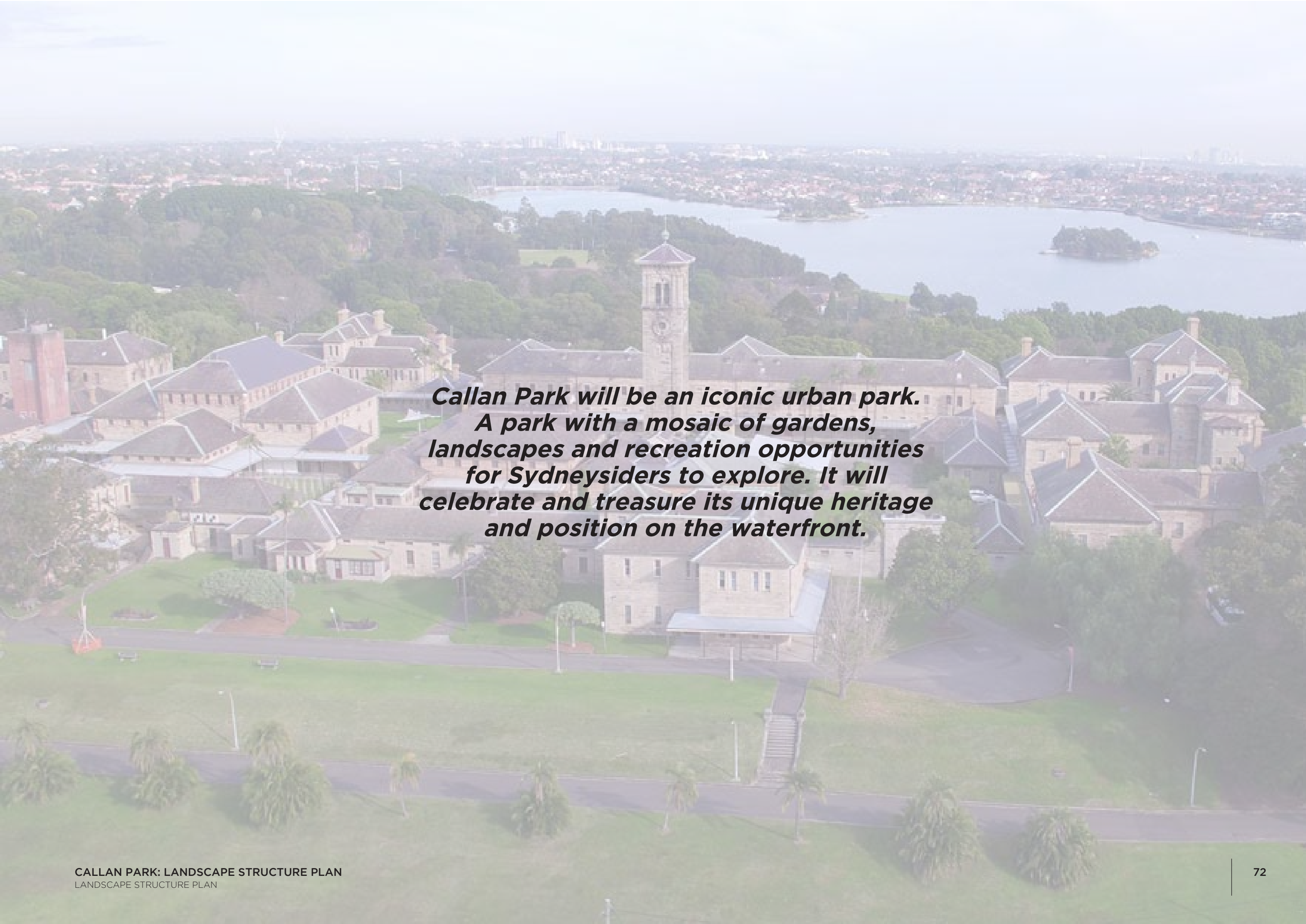

***Callan Park will be an iconic urban park.  
A park with a mosaic of gardens,  
landscapes and recreation opportunities  
for Sydneysiders to explore. It will  
celebrate and treasure its unique heritage  
and position on the waterfront.***